

en

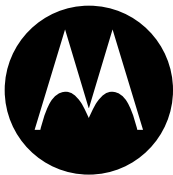

**moto** hint

let's get started



# Charging

**Note:** Fully charge your headset before use.

## Wireless Charging

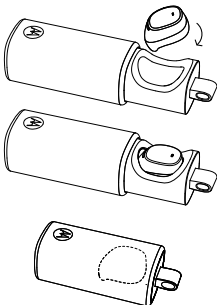

Insert headset and close case to begin charging. Headset is "on" when removed from the case. A fully charged case can recharge your headset twice.

## Wired Charging

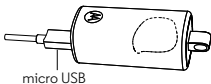

Charge the case and headset by plugging in the charging cable.

# Wearing

## Fit

Remove the headset from the case and carefully place in your ear.

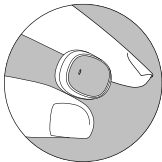

## Adjust

Twist your headset to make it fit comfortably.

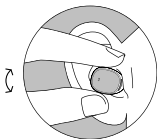

## Connect and go

Follow voice prompts to connect to your phone.



# Talking

## Call / Voice Touch area

Touch to answer/ignore a call or start voice commands.

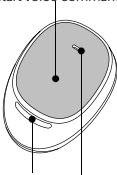

Front microphone

Back microphone



## Incoming call

<b>Answer</b>	Say “answer” or touch headset.
---------------	--------------------------------

<b>Ignore</b>	Say “ignore”.
---------------	---------------

**Note:** English only. See “Settings” on page 9 to turn on.

## Call options

<b>Voice command</b>	Touch headset. Say a command, like “Call Francis Martin, mobile”.
----------------------	---

**Note:** This feature is phone dependent.

<b>End call</b>	Touch headset.
-----------------	----------------

<b>Change volume</b>	Use your phone.
----------------------	-----------------

## Take headset out of ear to:

- Transfer a call to your phone.
- Pause music.

## Put headset in ear to:

- Answer an incoming call.
- Transfer a call to headset.
- Restart paused music.

# Moto Voice

Tell your Moto Hint headset what you want. Get directions, check voicemail, play your favorite song, or start a search using Moto Voice.

- If you have Moto Voice on your phone and have trained it with your launch phrase, you're ready to start using voice control.
- If you need to setup Moto Voice, go to the Moto application on your phone.

**Note:** You'll need the Moto Voice feature on your Moto X or Droid phone to use voice control on your Moto Hint. If your phone doesn't have Moto Voice, the headset still supports voice commands (see page 4).

# Lighting

## Headset light indicator

**In-ear**

Off.

**Remove  
from case**

Turns on briefly to show power to headset.

**Note:** You will hear a prompt when the battery is low.

## Charge case light indicator

### Wired charging of case and headset

**Headset in  
case**

Headset and case are charging.

**Case**

Case charging.

**Light**

**Charge status**

**Blinks  
white**

Charging.

**Solid white**

Fully charged.



## Wireless charging of headset

<b>Headset in case</b>	Charging.
<b>Light</b>	<b>Charge status</b>
<b>Blinks white</b>	Charging.
<b>Solid white</b>	Fully charged headset.

### Notes:

- To check if charging is complete open and shut the case.
- Lights turn off to save power. Headset will continue to charge until fully charged.

# Cleaning

Pull off the ear gel and inspect the opening for blockages. Remove any unwanted materials from the opening. Push the ear gel back on to the headset.

## Second device

Do you use two phones? Or a phone and a tablet? Connect with both of them.

- 1** Pair each device with the headset as normal. You don't have to turn off the first device to pair with the second one, as long as it's done within five minutes of turning on the headset.
- 2** Once paired, to connect with both devices simply turn them on. You'll hear "device (number) connected" as each device connects with your headset.

### Notes:

- **Two phones connected:** If you are on a call and you receive a call on the other phone. Touch the headset to answer the second call. End the second call to return to first call.
- **Two phones connected, not on a call:** Touch the headset to activate voice recognition on the first phone. Voice recognition only works on the first phone.

# Settings

Touch and hold the Call / Voice Touch area of the headset for 8 seconds, and then release. Headset will announce that it is in the "Settings Menu". Follow the voice prompts to turn features on or off:

- **Ear detect:** Sensor for audio detect when in ear.
- **Moto Voice:** Always on voice detection.
- **Voice prompts:** Voice dial calls, and more.
- **Caller ID alert:** Hear caller ID for incoming calls. Defaults to Off.
- **Wide-band audio:** Use HD Audio Plus for increased clarity and richer sound.
- **Voice answer:** Speak to answer incoming calls. Defaults to Off.
- **Pass through audio:** Allows ambient sound through headset.

**Note:** This feature is set to off. When turned on it will reduce power, talk and standby times.

- **Restore factory settings:** Reset default settings on your headset.

**Caution:** This erases all pairing information stored on the headset.

# Get what you need

**Support:** Visit  
[www.motorola.com/support](http://www.motorola.com/support).

**Bluetooth™:** Motorola accessories work with leading Bluetooth enabled devices. Motorola cannot guarantee compatibility with every Bluetooth product. For Bluetooth help, visit [www.motorola.com/bluetoothanswers](http://www.motorola.com/bluetoothanswers).

MOTOROLA and the Stylized M Logo are trademarks or registered trademarks of Motorola Trademark Holdings, LLC. All other product or service names are the property of their respective owners.

© 2014 Motorola Mobility LLC. All rights reserved.

Product ID: Moto Hint

QD ID: D023072

Manual Number: 68017902001-A

简体中文

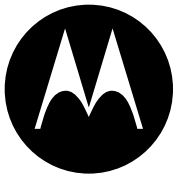

**moto** hint

入门指南



# 充电

**注意：**使用之前，请为耳机充满电。

## 无线充电

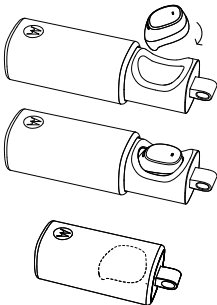

插入耳机并关闭耳机盒即可开始充电。从耳机盒中取出后，耳机处于“打开”状态。充满电的耳机盒可为耳机完成两次充电。

## 有线充电

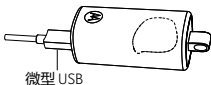

插入充电线缆可为耳机盒和耳机充电。

# 佩戴

## 贴合

从耳机盒中取出耳机，轻轻放入耳内。

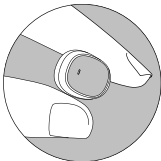

## 调整

扭动耳机，直至舒适贴合。



## 连接并通话

按照语音提示连接手机。





# 通话

## 呼叫/语音触摸区

触摸可接听/忽略呼叫或启动语音命令。

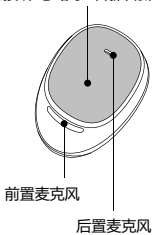

## 来电

### 接听

说“接听”或触摸耳机。

### 忽略

说“忽略”。

**注意：**仅限英语请参见第9页上的“设置”章节以了解如何打开此功能。

## 呼叫选项

### 语音命令

触摸耳机。说出命令，例如“呼叫 Francis Martin，手机”。  
**注意：**此功能因手机而异。

### 结束呼叫

触摸耳机。

### 更改音量

使用手机调节。

## 从耳中拿出耳机：

- 将呼叫转接到手机上。
- 暂停音乐。

## 将耳机放入耳中：

- 接听来电。
- 将呼叫转接到耳机上。
- 重新启动暂停的音乐。

# Moto Voice

您可以根据需要向 Moto Hint 耳机传达指令。通过 Moto Voice 可获取导航路线、检查语音邮件、播放心爱的歌曲或开始搜索。

- 如果您在手机上安装了 Moto Voice 并完成了启动短语训练，即可开始使用语音控制功能。
- 如果您需要设置 Moto Voice，请转到手机上的 Moto 应用程序。

**注意：**您需要在 Moto X 或 Droid 手机上安装 Moto Voice 功能，才能使用 Moto Hint 上的语音控制功能。即使您的手机没有 Moto Voice，该耳机也支持语音命令（请参见第 4 页）。

# 指示灯

## 耳机指示灯

**放入耳中**

熄灭。

**从耳机盒  
中取出**

短暂亮起，说明  
耳机已通电。

**注意：**如果电池电量低，将发出提示音。

## 耳机盒充电指示灯

**对耳机盒和耳机进行有线充电**

**耳机置于  
耳机盒中**

对耳机和耳机盒  
充电。

**空耳机盒**

对耳机盒充电。

**指示灯**

**充电状态**

**闪烁白光**

正在充电。

**持续白光**

电已充满。

## 对耳机进行无线充电

耳机置于耳机盒中	正在充电。
指示灯	充电状态
闪烁白光	正在充电。
持续白光	耳机已充满电。

### 注意：

- 要检查是否已经完成充电，请打开再关闭耳机盒。
- 指示灯将熄灭以节省电量。耳机将继续充电，直至充满。

# 清洁

取下耳胶并检查开孔中是否有堵塞。去除开孔中的各种堵塞物。将耳胶重新压入耳机。

## 第二部设备

您是否使用两部手机？或者您是否既有耳机，又有平板电脑？现在，您可以同时连接这两部设备。

- 1 按正常方式将每部设备与耳机配对。无需关闭第一部设备即可与第二部设备进行配对，前提是这项操作在打开耳机的五分钟之内完成。
- 2 配对完毕后，只需打开两部设备，即可同时与它们建立连接。当每部设备与耳机建立连接后，您都会听到“设备（号码）已连接”。

### 注意：

- 如果您已连接两部手机，现在正用一部手机通话，而另一部手机收到来电：触摸耳机可接听后一呼叫；结束后一呼叫可返回前一呼叫。
- 如果您已连接两部手机，且现在没有进行通话：触摸耳机可在第一部手机上激活语音识别功能。只有第一部手机能够进行语音识别。

# 设置

触摸并按住耳机上的呼叫 / 语音触摸区，持续 8 秒后松手。耳机将提示其已进入“设置”菜单。按照语音提示可打开或关闭下列功能：

- **耳内检测**：将耳机放入耳内时对声音进行感应检测。
- **Moto Voice**：始终打开语音检测。
- **语音提示**：语音拨号等。
- **来电显示提醒**：收听来电显示信息。默认为关闭状态。
- **宽波段音频**：使用 HD Audio Plus 获得更清晰、更浑厚的音质。
- **语音应答**：通过语音接听来电。默认为关闭状态。
- **直通音频**：允许周围的声音进入耳机。

**注意**：此功能设置为关闭。启用此功能后，将消耗电能，减少通话和待机时间。

- **恢复出厂设置**：重置手机上的默认设置。

**警示**：这将清除手机上存储的所有配对信息。

# 获取所需帮助

**支持：**请访问

[www.motorola.com/support](http://www.motorola.com/support)。

**Bluetooth™：**摩托罗拉配件产品可兼容主流的支持蓝牙的设备。但摩托罗拉无法保证与所有蓝牙产品都兼容。有关蓝牙的帮助信息，请访问：

[www.motorola.com/bluetoothanswers](http://www.motorola.com/bluetoothanswers)。

MOTOROLA 和标志性的 M 徽标是 Motorola Trademark Holdings, LLC. 的商标或注册商标。所有其他产品或服务名称均为其各自所有者所有。

© 2014 Motorola Mobility LLC。保留所有权利。

产品 ID：Moto Hint

QD ID：D023072

手册编号：68017902001-A







**motorola.com**



Please recycle!  
请回收！